

August 7, 1991
323-S.nxsooscrk.ord

Introduced by: GREG NICKELS

Proposed No.: 91 - 676

ORDINANCE NO. **10100**

AN ORDINANCE relating to the annexation of an area known as 323-S to Soos Creek Water and Sewer District for sewer service.

STATEMENT OF FACT:

1. A notice of intention proposing the annexation of an area for sewer service known as 323-S to Soos Creek Water and Sewer District was filed with the county council effective August 7, 1991.
2. Soos Creek Water and Sewer District has found the petition for annexation to be sufficient and has, by Resolution No. 0683-S concurred with the proposed annexation.
3. Soos Creek Water and Sewer District filed a Declaration of Non-significant Impact dated June 20, 1991, on the proposed annexation.
4. The county council held a public hearing on the 3rd day of September, 1991 and has considered the criteria set forth in R.C.W. 56.02.060.

BE IT ORDAINED BY THE COUNCIL OF KING COUNTY:

SECTION 1. The annexation of Soos Creek Water and Sewer District of the area known as 323-S and described in Section 4 herein is approved. This proposed annexation is consistent with R.C.W. 56.02.060 as described in the attached King County Council Annexation Report on 323-S.

SECTION 2. The Soos Creek Water and Sewer District is the appropriate entity to serve the area proposed to be annexed.

SECTION 3. Completion of this annexation does not constitute county approval or disapproval of any other permits, franchises, certifications, or actions necessary to provide service to this annexation area, nor does it authorize sewer service in any area not designated as a "Local Service Area" by the King County Sewerage General Plan.

1
2
3
4
5
6
7
8
9
10
11
12
13
14
15
16
17
18
19
20

SECTION 4. The area known as 323-S to be annexed is described as follows:

The East 276.89 feet of the North 135.00 feet of the North one-half of the South one-half of the North one-half of the Southeast one-quarter of the Northeast one-quarter of Section 28, Township 22 North, Range 5 East, W.M., in King County, Washington.

INTRODUCED AND READ for the first time this 19th day of August, 1991.

PASSED this 9th day of September, 1991.

KING COUNTY COUNCIL
KING COUNTY, WASHINGTON

Lois North
Chair

ATTEST:

Gerald A. Lotun
Clerk of the Council

APPROVED this 20th day of September, 1991.

Jim Hill
King County Executive

SOOS CREEK WATER AND SEWER DISTRICT

PROPOSED ANNEXATION 323-S 10100

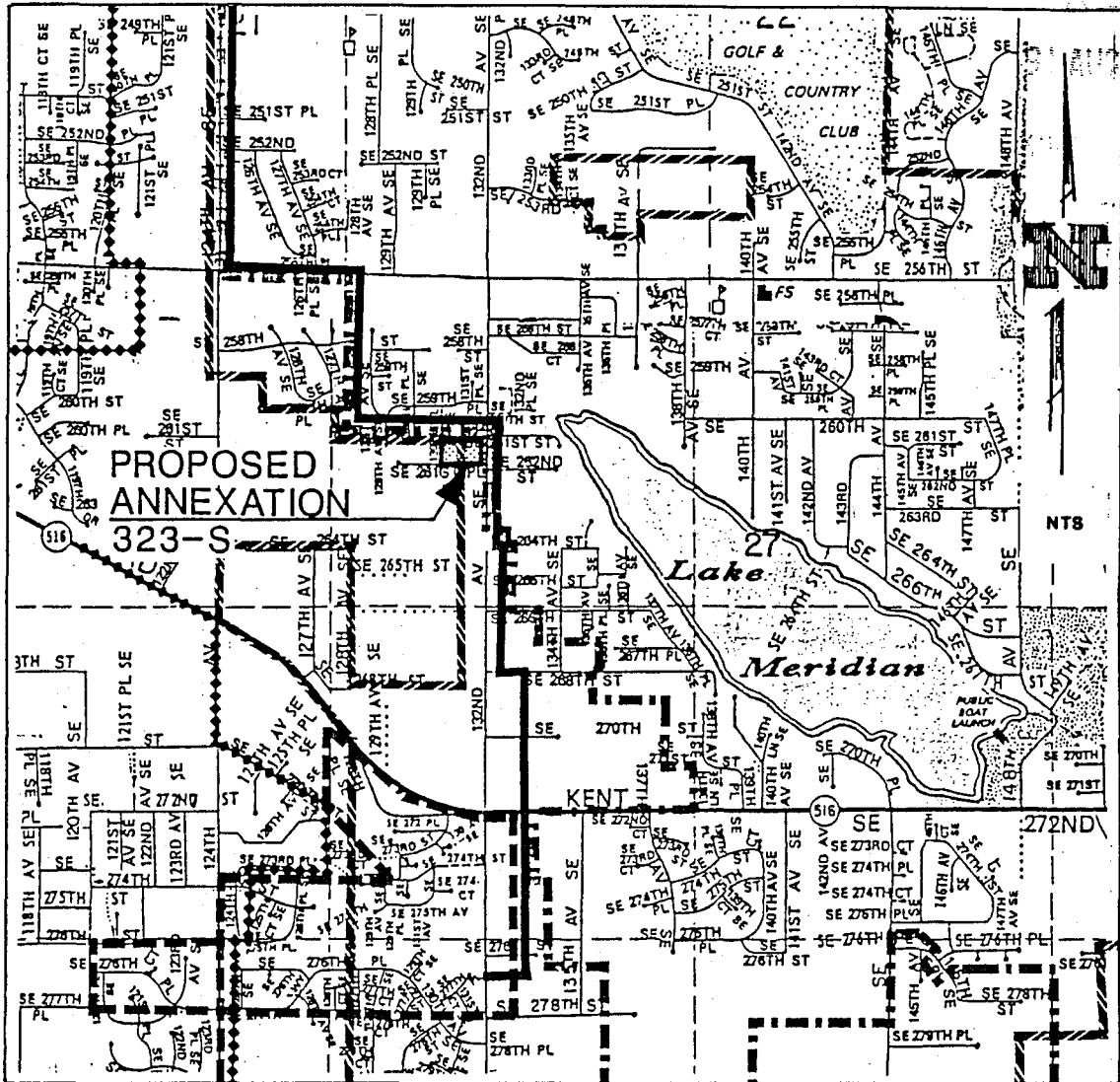

PROPOSED ANNEXATION 323-S
(SEWER SERVICE AREA)



SOOS CREEK WATER AND SEWER DISTRICT
(SEWER SERVICE AREA)



SOOS CREEK LOCAL SERVICE AREA
(SEWER SERVICE AREA)



KENT MUNICIPAL SEWER DISTRICT



WATER DISTRICT 111



KENT MUNICIPAL WATER DISTRICT



ALL MAP WITHIN FIRE DISTRICT NO. 37

ALL MAP WITHIN KING COUNTY SCHOOL DISTRICT NO. 415

ALL MAP WITHIN INCORPORATED KING COUNTY

EXHIBIT "I"